

# REPLACEMENT FRONT SEATBELT FITTING INSTRUCTIONS

## WB HOLDEN STATESMAN 1983-1985

### QUALITY AND CERTIFICATION

This assembly carries the certification mark of Benchmark Australia and if installed in accordance with these instructions will provide the required degree of protection to the wearer, in most type of accidents.

Accompanying these installation instruction are further instructions for the wearer of the belt assembly. The installer should ensure that these instructions are passed on to the owner.

### NOTE

- This seat belt assembly should be installed by a competent mechanic at an appropriate fitting station.
- These fitting instructions should be read carefully before commencing installation of belt.

### WARNING!

- To the installer: Please read the whole of the instructions for installation carefully and consult Klippan Safety Products in the event of doubt as to the method of installation.
- Ensure that the correct installation diagram is followed for your particular vehicle.
- Also read the General Information and Safety Check-List notes carefully.
- Install the belts directly in accordance with instructions to obtain maximum efficiency. Any deviation could adversely affect the performance of the belt in an accident.
- Please leave the 'General Instructions for Use of Seat Belts' in the vehicle so that the owner may read them.

### INERTIA REEL FITTMENT

1. Move front seat forward.
2. Remove trim panel to gain access to belt anchor bolts (Fig.1).
3. Unbolt the anchor plate (Fig.1) and discard the faulty belt.
4. Position the replacement belt (Fig. 2).
5. Remove all twist from the webbing, between the retractor and the anchor plate section.
6. Apply body sealer sparingly to any floor holes. Attach anchor plate to the body or using bolts, spacers and washers, supplied with the new belt assembly. (Install in the reverse order of removal, or as per installation diagram Fig.2).
7. Ensure the bolts are securely seated, then torque to 30-35Nm as shown on the installation diagram.

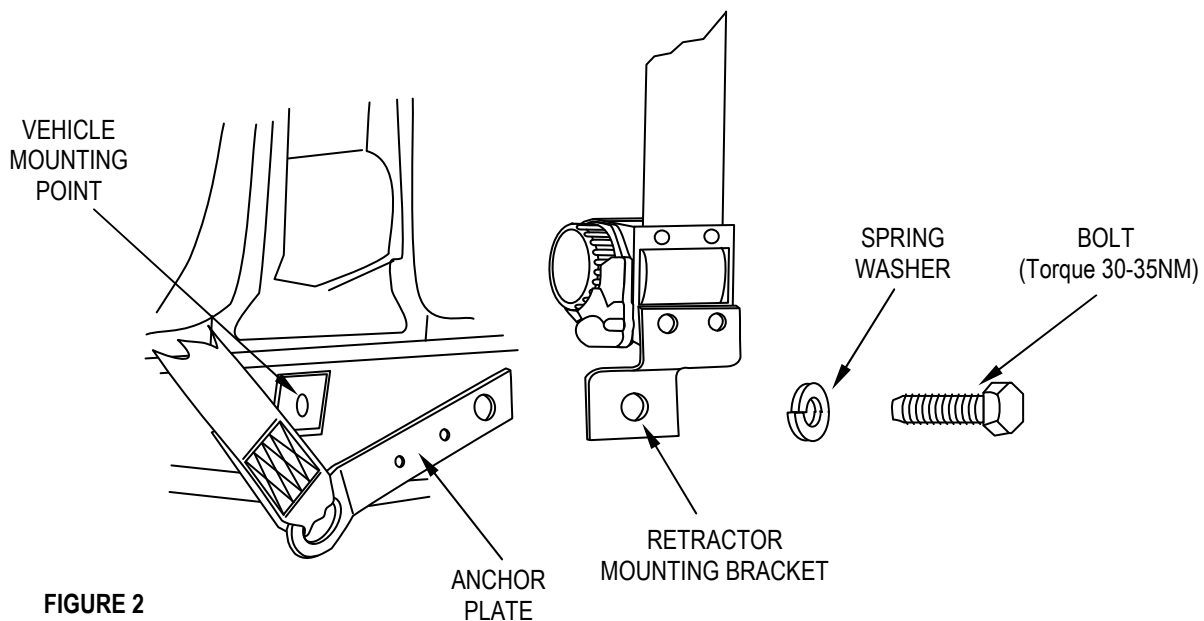
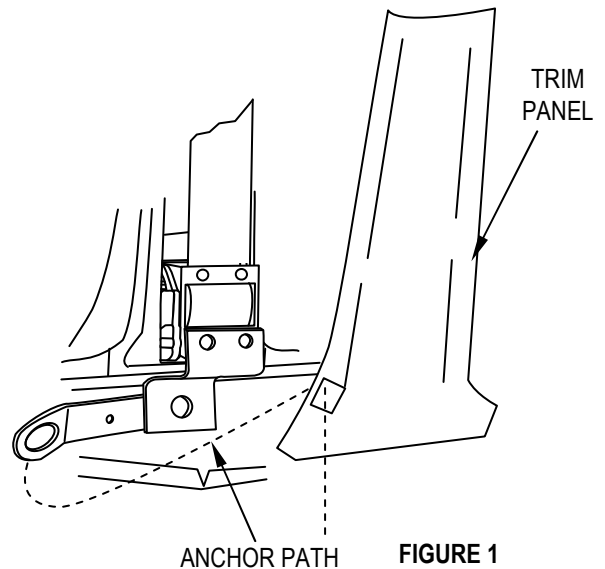

# REPLACEMENT FRONT SEATBELT FITTING INSTRUCTIONS

## WB HOLDEN STATESMAN 1983-1985

### SASH GUIDE FITTMENT

1. Attach Sash Guide to the Pillar using bolts, spacers and washers, supplied with the new belt assembly. (Install in the reverse order of removal, or as per installation diagram).
2. Ensure the bolts are securely seated, then torque to 30-35Nm.
3. Check that the shoulder anchor is seated correctly, and will rotate freely after the bolt is tightened.

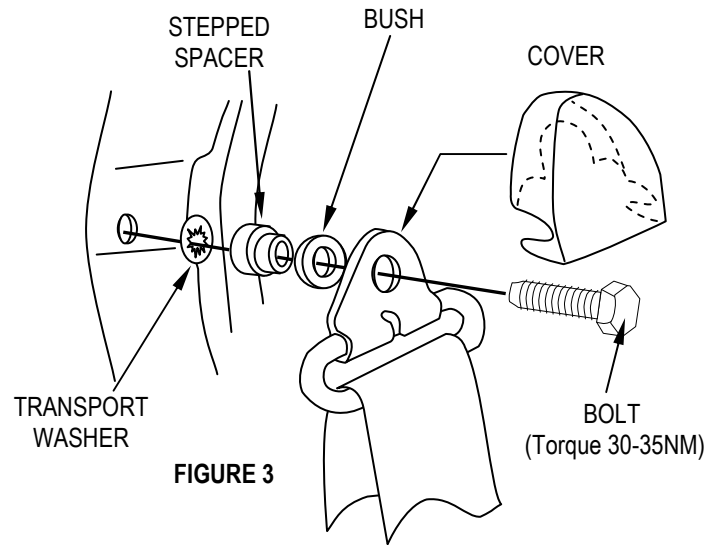

**FIGURE 3**

### BUCKLE FITTMENT

1. Move the front seat forward to allow removal of anchor attaching hardware.
2. Remove the bolt, spacer and washers from the stalk buckle. Discard the faulty stalk buckle.
3. Position the replacement stalk buckle on the side of the transmission tunnel.
4. Ensure the buckle is facing correctly so that the press button can accessed easily when the tongue and buckle are engaged.
5. Apply body sealer sparingly to any floor holes. Attach stalk to the transmission tunnel using bolt, and washers, supplied with the new stalk buckle assembly. (Install as per installation diagram fig.4).
6. Ensure the bolts are securely seated, then torque to 30-35Nm as shown on the installation diagram.
7. Check the operation of the stalk buckle.

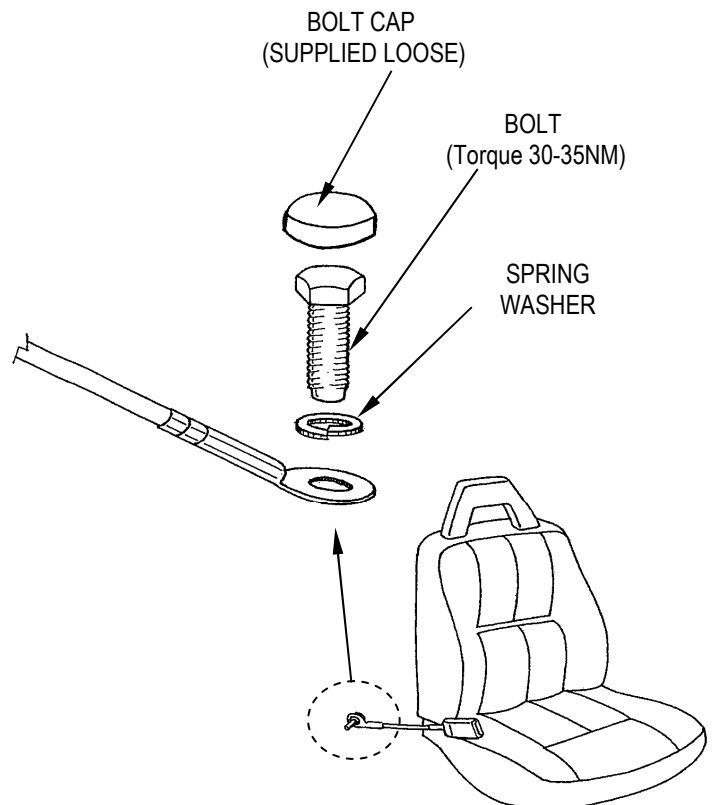

**FIGURE 4**